

## 1986 - 1993 Ford Mustang 5.0L Short Tube Headers

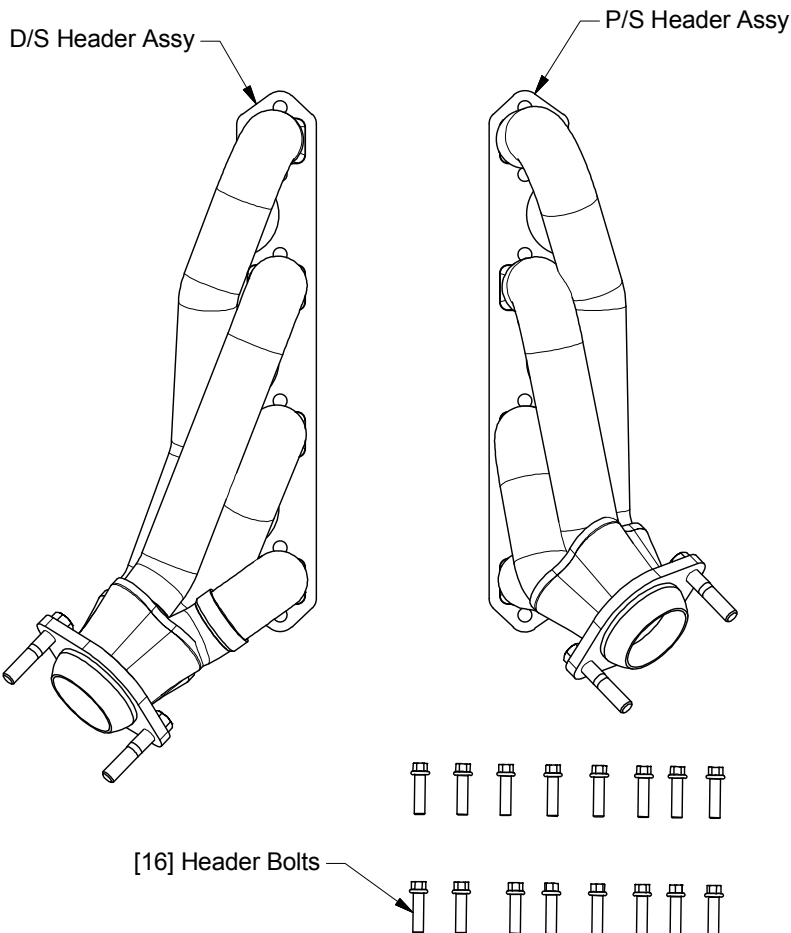

**Warning:** When working on, under, or around any vehicle exercise caution. Please allow the vehicle's exhaust system to cool before removal, as exhaust system temperatures may cause severe burns. If working without a lift, always consult vehicle manual for correct lifting specifications. Always wear safety glasses and ensure a safe work area. Serious injury or death could occur if safety measures are not followed.

**Step 1:** (Carefully read all instructions before installation) Disconnect the battery (Fig # 1). Unbolt the air intake at the airbox intake by loosening the retaining band clamp. This will allow you to rotate the engine for easier access. Disconnect the rear O2 sensor plugs (Fig # 2). Disconnect the air injection hose. Loosen the clamps attaching the X-Pipe assembly. Unbolt the X-Pipe flanges at the catalytic converter assemblies using a 15mm socket (Fig # 3). The X-Pipe converter assembly may now be removed. When disengaging the steering shaft first mark both the shaft and the universal joint to ensure alignment on reassembly (Fig # 4). Remove the retaining bolts using a 7/16" 12 point socket and uncouple the steering shaft. All eight header nuts may now be removed using a 14mm socket (Fig # 5). The header may now be removed.

**Step 2:** To install the new drivers side headers identify and lay out the two subassemblies to ensure correct orientations. Install the D/S header assembly. Use the supplied gasket and header bolts to secure to the manufacturers torque specifications. Install the P/S front in a similar fashion. The engine may need to be raised with the jack for added clearance (Fig # 6). Reconnect the steering shaft, be sure to align the marks you previously made.

### Parts List:

1. D/S Header Sub Assy.
2. P/S Header Sub Assy.
3. [16] Header Bolts.
4. [2] Manifold Gaskets.

**\*\* Magnaflow Performance Exhaust recommends professional installation on all their products**

### 1986 - 1993 Ford Mustang 5.0L Short Tube Headers



Fig # 1.



Fig # 2.

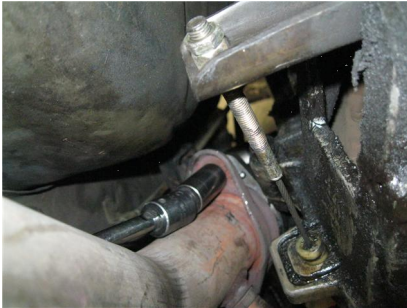

Fig # 3.

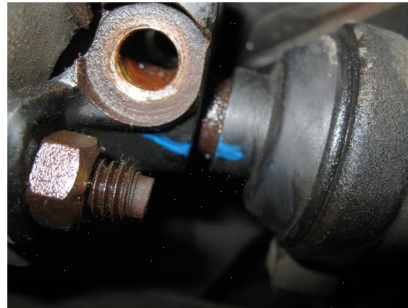

Fig # 4.



Fig # 5.



Fig # 6.

**Warning:** When working on, under, or around any vehicle exercise caution. Please allow the vehicle's exhaust system to cool before removal, as exhaust system temperatures may cause severe burns. If working without a lift, always consult vehicle manual for correct lifting specifications. Always wear safety glasses and ensure a safe work area. Serious injury or death could occur if safety measures are not followed.

**Step 3:** To remove the passengers side header assembly you will need to remove the starter motor. Unbolt using a 13mm socket and remove. The remaining removal process is the same as the drivers side.

**Step 4:** Installing the passengers side header assembly is essentially the same as the drivers side. Install the header assembly with the supplied gasket and attach using the supplied header bolts to the manufacturers torque specifications. Replace the starter motor. Check both sets of headers for clearance. Fasten each header assembly flange to the OEM catalytic converters and X-Pipe assembly using the existing hardware using a 15mm socket. Reattach the O2 sensor plugs and reconnect the air injection hose.

**Step 5:** With all components mounted loosely, adjust the system for overall aesthetics and clearance of frame & bodywork. (MAGNAFLOW recommends at least 1/2" of clearance between the exhaust system and any body panels to prevent heat-related body damage or fire.) Install the air intake and reconnect the battery.

**Step 6:** Once a final position has been chosen for the new system, evenly tighten all fasteners from front to rear. The supplied band clamps must be VERY tight to properly align the pipes and prevent leaks. Inspect all fasteners after 25-50 miles of operation and retighten if necessary.

**\*\* Magnaflow Performance Exhaust recommends professional installation on all their products**